

**Application**

Volumetric/gravimetric feeder for non free flowing powders and pellets, premixes, fibres, grinded materials, micro-pellets.

**Volumetric dosing unit SCHOLZ-FLEX80**

Single screw feeders with flexible hopper

Material: stainless steel 1.4301, PU-Hopper

Dimensions: L: 600 mm B: 600 mm H: 420 mm

Available Round Hopper: 40, 100, 200 liters

hoppers: Basic Hopper: 125, 175 liters

Screw: 230/400 VAC 50 Hz gear-motor  
Red. A=5,1 (max. 4750 liters/h,  
dependent on process)  
Red. B=17,8 (max. 2700 liters/h)  
Red. C=60,5 (max. 800 liters/h)  
(Output with completely filled screw)

Paddles: FU LENZE: 3 to 100 Hz  
230/400 VAC 50 Hz gear-motor  
Red. B=58,9

FU LENZE: 3 to 100 Hz

Weight: approx. 80 kg

Option: Vertical or horizontal agitator

Output-rate: approx. 25 liters/h to 9500 liters/h

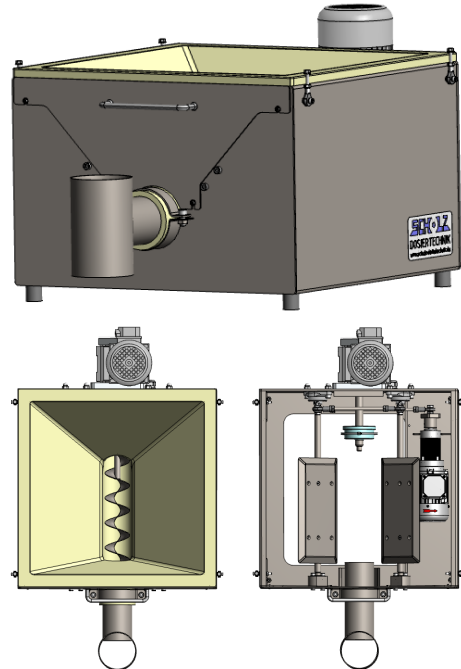

Exchangeable dosing tools allow the ideal adaptation of output-rate and bulk density.

Screws from Ø 31 mm to Ø 75 mm

Tubes (horizontal / vertical outlet) from Ø 31 mm to Ø 80 mm

**Loss-in-Weight Feeder type: SOLID**

The **SCHOLZ-FLEX80** - single screw feeder as described above is mounted on a **BASIC600** - Scale.

**Scale:** **BASIC600**

**Weight capacity:** 300 kg

**Dimensions scale:** 600 x 600 mm

**Dimensions compl.:** 690 x 600 x 150 mm

**Material of**

**components:** Aluminium/ high-grade

steel

**Construction:** plug and play

**Weight:** 30 kg

The **CON-TRUST** control system generates individual - and multiple - feeder control.



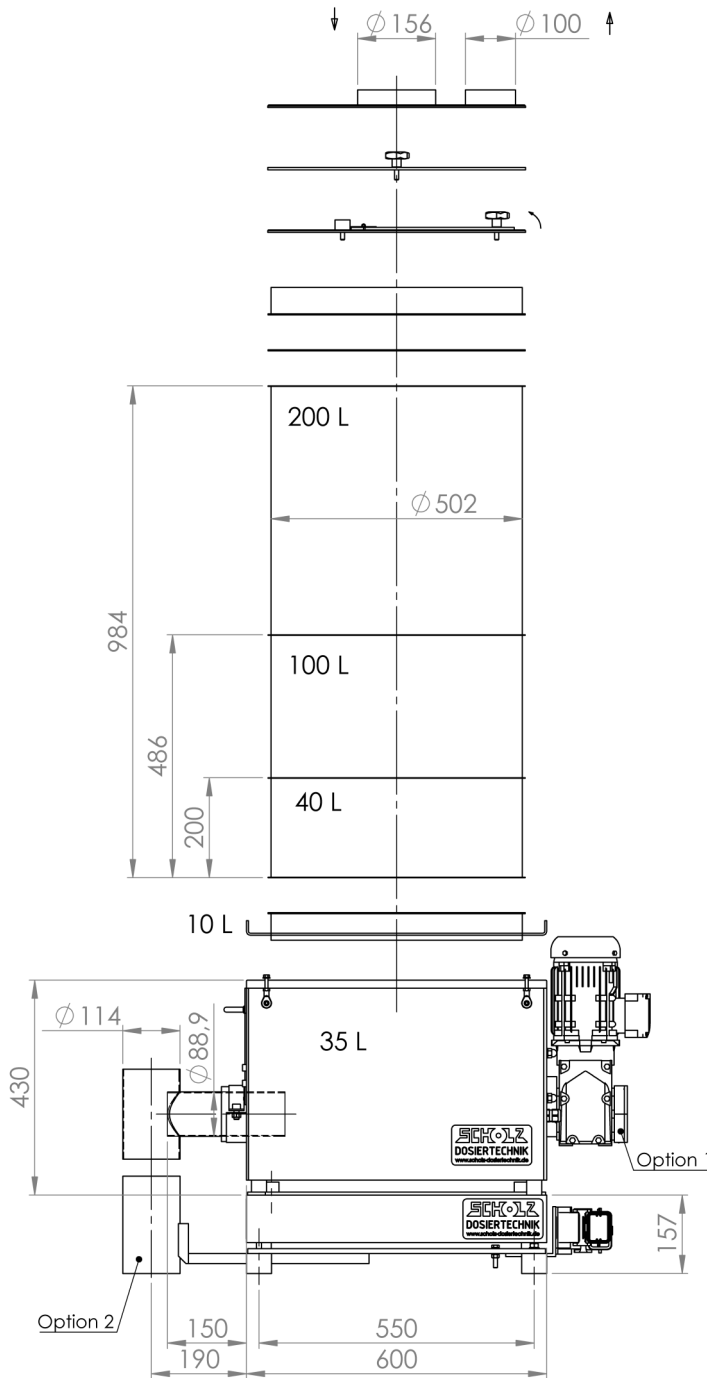

**AUTO LID**

ALR-5 3,0 kg

**MANUAL LID**

MLR-5 2,8 kg

**FLAP LID**

FLR-5 3,5 kg

**SAFETY GRID**

GAR-5 1,6 kg  
 SGR-5 0,7 kg

**BASIC HOPPER**

RH-200-510 25,0 kg  
 RH-100-55 12,0 kg  
 RH-40-52 4,0 kg

**BASIC FLANGE**

BF-500 7,5 kg

**FEEDER**

FLEX80 80,0 kg  
 Option 1  
 FLEX80-RC 0,5 kg  
 RUN CONTROL

**SCALE**

BASIC600 30,0 kg  
 Option 2  
 BASIC600-OC 2,1 kg  
 OUTLET COMPENSATION

Differential-Dosierwaage SOLID  
 Loss-in-Weight-Feeder SOLID